

# WOUND CHIP INDUCTORS → FLC□□□□□NLCL : High Current Type

## FEATURES

1. Very strong solderability by soldering flow and soldering iron.
2. Highly accurate dimensions , can be mounted automatically.
3. Terminals are highly resistant to pulling force.
4. Highly resistant to mechanical shock and pressure.
5. Highly reliable in environments of sudden temperature change and humidity. Super Q characteristics.

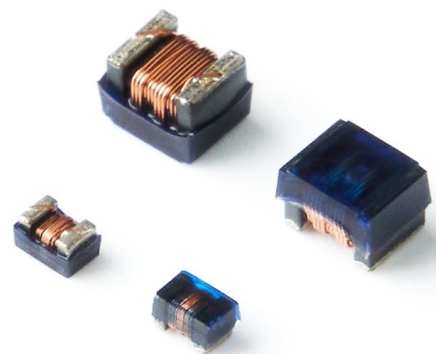

## APPLICATIONS

1. Microtelevisions , Liquid Crystal Display, video camera , portable VCRs , car radio , car stereo , thin tape radio , television tuners , mobile telephone, radio and other electronic devices.
2. Modem , OA products , TV sets , VCR , Etc.

## ORDERING CODE

FLC201212NLCL- R33 M A08 T  
 (1) (2) (3) (4) (5)

(1) PRODUCT TYPE CODE AND SIZE CODE

(2) INDUCTANCE

(3) INDUCTANCE TOLERANCE

( J : ±5%, K : ±10%, M : ±20%, N : ±30%)

(4) A□□ means HIGH CURRENT RATING

Example : A03 means 300mA, A13 means 1300mA

(5) REEL TAPING

TERMINAL WRAPAROUND :

FLC160808NLCL : Approx. 0.008"/0.20mm BOTH ENDS

FLC201212NLCL : Approx. 0.015"/0.38mm BOTH ENDS

FLC252018NLCL : Approx. 0.015"/0.38mm BOTH ENDS

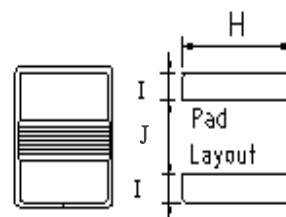
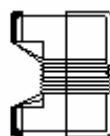
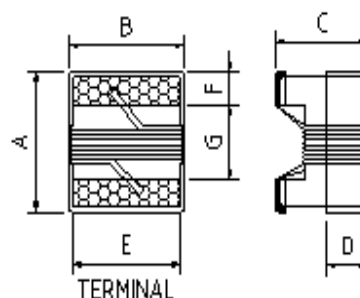

## SHAPE & DIMENSIONS

UNIT:mm (inch)

SIZE CODE	A Max.	B Max.	C Max.	D Ref.	E	F	G	H	I	J
FLC160808NLCL (0603)	1.80 (0.071)	1.22 (0.048)	1.07 (0.042)	0.38 (0.015)	0.90 (0.035)	0.31 (0.012)	0.93 (0.037)	1.02 (0.040)	0.64 (0.025)	0.64 (0.025)
FLC201212NLCL (0805)	2.35 (0.093)	1.78 (0.070)	1.60 (0.063)	0.51 (0.020)	1.27 (0.050)	0.51 (0.020)	1.02 (0.040)	1.78 (0.070)	1.02 (0.040)	0.76 (0.030)
FLC252018NLCL (1008)	2.92 (0.115)	2.79 (0.110)	2.23 (0.088)	0.51 (0.020)	2.03 (0.080)	0.51 (0.020)	1.52 (0.060)	2.54 (0.100)	1.02 (0.040)	1.27 (0.050)

※All the data listed in this catalogue are for reference only, King Core reserves the right to alter or revise the specifications without prior notification.

# WOUND CHIP INDUCTORS → FLC□□□□□NLCL : High Current Type

## ELECTRICAL CHARACTERISTICS

ORDERING CODE	Inductance ( $\mu\text{H}$ )	Q Min	Test Frequency L/Q(MHz)	SRF (MHz)min	DC Resistance ( $\Omega$ )max	IDC (mA)max
FLC160808NLCL47NMA16T01	0.047	12	7.96	1500	0.061	1600
FLC160808NLCL72NMA16T01	0.072	12	7.96	1400	0.117	1600
FLC160808NLCLR10MA15T01	0.10	12	7.96	1150	0.142	1500
FLC160808NLCLR12MA15T01	0.12	12	7.96	1100	0.170	1500
FLC160808NLCLR15MA14T01	0.15	15	7.96	1050	0.170	1400
FLC160808NLCLR18MA14T01	0.18	15	7.96	950	0.200	1400
FLC160808NLCLR24MA12T01	0.24	15	7.96	800	0.220	1200
FLC160808NLCLR27MA11T01	0.27	15	7.96	775	0.260	1100
FLC160808NLCLR33MA09T01	0.33	15	7.96	725	0.450	900
FLC160808NLCLR39MA09T01	0.39	15	7.96	620	0.460	900
FLC160808NLCLR47MA09T01	0.47	15	7.96	540	0.470	900
FLC160808NLCLR56MA09T01	0.56	15	7.96	525	0.490	900
FLC160808NLCLR68MA08T01	0.68	15	7.96	260	0.550	800
FLC160808NLCLR78MA08T01	0.78	15	7.96	460	0.730	800
FLC160808NLCLR82MA08T01	0.82	15	7.96	410	0.730	800
FLC160808NLCL1R0MA07T01	1.0	15	7.96	190	0.850	700
FLC160808NLCL1R2MA06T01	1.2	15	7.96	160	0.900	600
FLC160808NLCL1R5MA05T01	1.5	15	7.96	100	1.000	500
FLC160808NLCL1R8MA05T01	1.8	15	7.96	80	1.100	500
FLC160808NLCL2R2MA05T01	2.2	15	7.96	68	1.300	500
FLC160808NLCL2R7MA05T01	2.7	15	7.96	60	1.400	500
FLC160808NLCL3R3MA04T01	3.3	15	7.96	42	1.520	400
FLC160808NLCL3R9MA04T01	3.9	15	7.96	40	1.550	400
FLC160808NLCL4R7MA04T01	4.7	15	7.96	34	1.900	400
FLC160808NLCL5R6MA04T01	5.6	15	7.96	32	2.100	400
FLC160808NLCL6R8MA03T01	6.8	15	7.96	31	2.900	300
FLC160808NLCL7R8MA03T01	7.8	15	7.96	28	3.200	300
FLC160808NLCL8R2MA03T01	8.2	15	7.96	26	3.200	300
FLC160808NLCL100MA03T01	10.0	12	2.52	25	3.800	300

- 1.IDC: ( $\Delta T$ ) within 40°C
- 2.& Inductance drop less than 20% typ.
3. Operating temperature range : -25°C ~ +85°C (including self-heating)

※All the data listed in this catalogue are for reference only, King Core reserves the right to alter or revise the specifications without prior notification.



**KING CORE ELECTRONICS INC.**

Tel:886-3-4698855

Fax:886-3-4691395

No.269,Nanfong Rd.,Pingjhen City,Taoyuan County, Taiwan

E-mail:kc@mail.kingcore.com.tw

Web Site:http://www.kingcore.com.tw

# WOUND CHIP INDUCTORS → FLC□□□□□NLCL : High Current Type

## ELECTRICAL CHARACTERISTICS

ORDERING CODE	Inductance	Tolerance	Q	Test	SRF	DC	IDC
	( $\mu$ H)	$\pm\%$	Min	Frequency L/Q(MHz)	(MHz)TYP	Resistance ( $\Omega$ )max	(mA)max
FLC201212NLCLR33MA15T01	0.33	20%	15	25.2/7.96	800	0.20	1500
FLC201212NLCLR47MA13T01	0.47	20%	15	25.2/7.96	800	0.25	1300
FLC201212NLCLR56MA12T01	0.56	20%	15	25.2/7.96	600	0.27	1200
FLC201212NLCLR68MA12T01	0.68	20%	15	25.2/7.96	600	0.29	1200
FLC201212NLCLR82MA11T01	0.82	20%	15	25.2/7.96	550	0.32	1100
FLC201212NLCL1R0MA10T01	1.0	20%	15	7.96	200	0.37	1000
FLC201212NLCL1R2MA06T01	1.2	20%	15	7.96	200	0.66	600
FLC201212NLCL1R8MA06T01	1.8	20%	15	7.96	120	0.84	600
FLC201212NLCL2R2MA06T01	2.2	20%	15	7.96	110	0.97	600
FLC201212NLCL2R7MA06T01	2.7	20%	15	7.96	100	1.10	600
FLC201212NLCL3R3MA06T01	3.3	20%	15	7.96	70	1.15	600
FLC201212NLCL3R9MA05T01	3.9	20%	15	7.96	60	1.25	500
FLC201212NLCL4R7MA05T01	4.7	20%	15	7.96	50	1.34	500
FLC201212NLCL5R6MA04T01	5.6	20%	15	7.96	45	1.64	400
FLC201212NLCL6R8MA04T01	6.8	20%	15	7.96	45	1.75	400
FLC201212NLCL8R2MA04T01	8.2	20%	15	7.96	40	1.85	400
FLC201212NLCL100MA03T01	10	20%	15	2.52	35	2.07	300
FLC201212NLCL120MA03T01	12	20%	15	2.52	25	2.35	300
FLC201212NLCL150MA028T01	15	20%	15	2.52	23	2.67	280
FLC201212NLCL180MA028T01	18	20%	15	2.52	21	3.00	280
FLC201212NLCL220MA025T01	22	20%	15	2.52	20	4.10	250
FLC201212NLCL270MA022T01	27	20%	15	2.52	18	4.60	220
FLC201212NLCL330MA02T01	33	20%	15	2.52	17	5.10	200
FLC201212NLCL390MA018T01	39	20%	15	2.52	15	7.10	180
FLC201212NLCL470MA015T01	47	20%	15	2.52	15	7.60	150

- 1.IDC: ( $\Delta$ T) within 40°C
- 2.& Inductance drop less than 20% typ.
- 3. Operating temperature range : -25°C ~ +85°C (including self-heating)

※All the data listed in this catalogue are for reference only, King Core reserves the right to alter or revise the specifications without prior notification.

# WOUND CHIP INDUCTORS → FLC□□□□□NLCL : High Current Type

## ELECTRICAL CHARACTERISTICS

ORDERING CODE	Inductance	Tolerance	Q	Test Frequency	SRF	DC	IDC
	( $\mu$ H)	$\pm\%$	Min	L/Q(MHz)	(MHz)TYP	Resistance ( $\Omega$ )max	(mA)max
FLC252018NLCL1R0MA13T01	1.0	20%	25	7.96	200	0.26	1300
FLC252018NLCL1R2MA12T01	1.2	20%	20	7.96	280	0.34	1200
FLC252018NLCL1R5MA11T01	1.5	20%	20	7.96	250	0.36	1100
FLC252018NLCL1R8MA11T01	1.8	20%	20	7.96	170	0.42	1100
FLC252018NLCL2R2MA11T01	2.2	20%	20	7.96	130	0.45	1100
FLC252018NLCL2R7MA09T01	2.7	20%	20	7.96	130	0.50	900
FLC252018NLCL3R3MA08T01	3.3	20%	20	7.96	80	0.59	800
FLC252018NLCL3R9MA08T01	3.9	20%	20	7.96	50	0.61	800
FLC252018NLCL4R7MA08T01	4.7	20%	20	7.96	45	0.66	800
FLC252018NLCL5R6MA07T01	5.6	20%	17	7.96	42	0.76	700
FLC252018NLCL6R8MA07T01	6.8	20%	17	7.96	39	0.84	700
FLC252018NLCL8R2MA06T01	8.2	20%	15	7.96	36	0.93	600
FLC252018NLCL100MA05T01	10	20%	15	2.52	33	1.03	500
FLC252018NLCL120MA05T01	12	20%	15	2.52	30	1.10	500
FLC252018NLCL150MA04T01	15	20%	15	2.52	26	2.10	400
FLC252018NLCL180MA04T01	18	20%	15	2.52	24	2.30	400
FLC252018NLCL220MA04T01	22	20%	15	2.52	22	2.50	400
FLC252018NLCL270MA04T01	27	20%	15	2.52	13	3.35	400
FLC252018NLCL330MA04T01	33	20%	15	2.52	11	3.66	400
FLC252018NLCL390MA03T01	39	20%	15	2.52	11	5.70	300
FLC252018NLCL470MA02T01	47	20%	15	2.52	10	6.20	200

- 1.IDC: ( $\Delta T$ ) within 40°C
- 2.& Inductance drop less than 20% typ.
3. Operating temperature range : -25°C ~ +85°C (including self-heating)

\* Design as Customer's Requested Specifications.

※All the data listed in this catalogue are for reference only, King Core reserves the right to alter or revise the specifications without prior notification.