

# SPECIFICATION OF RCQ SERIES

## APPLICATIONS

### AEC-Q200



Enclosures for channel-type EMI suppressor snapes.

- \* Internal and external power cables
- \* Internal cables between PC boards and data connectors
- \* Compatible with Pb-free RoHS and AEC-Q200
- \* Material :K17
- \* Initial Permeability:750
- \* Case Flame Resistant Rating:UL94V-0
- \* Plastic Housing Color:Grey
- \* Curie Temperature:-50 up to +175 °C



## ORDERING CODE

K17 RCQ 10\*20\*5 -MG1

(1) (2) (3) (4) (5) (6)

- (1) MATERIAL
- (2) PRODUCT CODE
- (3) CORE OD
- (4) CORE LENGTH
- (5) CORE ID
- (6) PLASTIC CLAMPS

## SHAPE

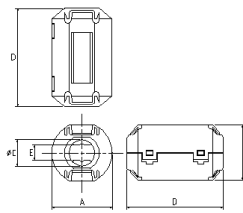

FIG 1

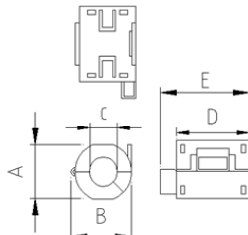

FIG 2

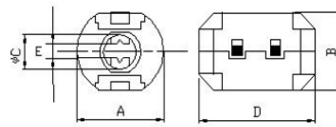

FIG 3

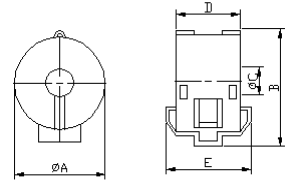

FIG 4

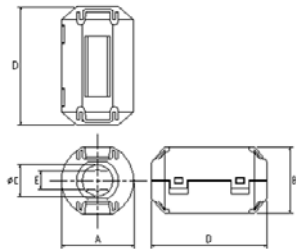

FIG 5

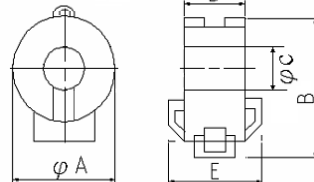

FIG 6

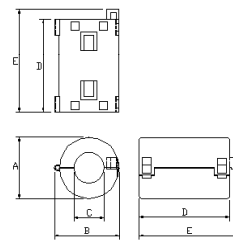

FIG 7

## DIMENSIONS & CHARACTERISTICS

UNIT:mm

NO.	ORDERING CODE	A	B	C	D	E	IMPEDANCE(Ω)	IMPEDANCE(Ω)	Applicable cable(max)	Fig
							25MHz (TYP)	100MHz ±25%		
1	K17 RCQ 10*20*5-MG1	13.00±1.00	12.00±1.00	5.00±1.00	25.50±1.00	2.40±0.50	101	218	3.5	1
2	K17 RCQ 12*15*7-MG1	14.00±1.00	15.50±1.00	7.00±1.00	18.00±1.00	22.00±1.00	67	152	7	2
3	K17 RCQ 13*23*7-MG1	17.00±1.00	15.00±1.00	7.00±1.00	30.00±1.00	3.00±1.00	104	224	4	3
4	K17 RCQ 16*13*8-MG1	19.50±1.00	23.00±1.00	8.00±1.00	17.00±1.00	23.00±1.00	65	166	8	4
5	K17 RCQ 16*16*8-MG1	19.20±1.00	23.40±1.00	8.20±1.00	20.00±1.00	26.10±1.00	76	192	8	4
6	K17 RCQ 16*28*9-M2G3	20.00±1.00	18.00±1.00	9.50±1.00	36.00±1.00	6.50±1.00	117	245	9	5
7	K17 RCQ 20*30*13-MG1	23.00±1.00	22.00±1.00	13.50±1.00	36.00±1.00	10.00±1.00	100	215	12	5
8	K17 RCQ 24*14*11.5-MG1	28.00±1.00	31.50±1.00	11.50±1.00	18.00±1.00	24.00±1.00	78	186	11.5	6
9	K17 RCQ 26*30*13-MG3	30.75±1.00	31.00±1.00	13.00±1.00	34.00±1.00	39.00±1.00	156	305	13	7

※Other sizes are available upon request.

※All the data listed in this catalogue are for reference only, King Core reserves the right to alter or revise the specifications without prior notification.

# SPECIFICATION OF RCQ SERIES

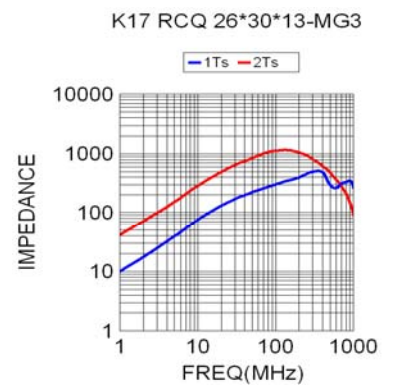
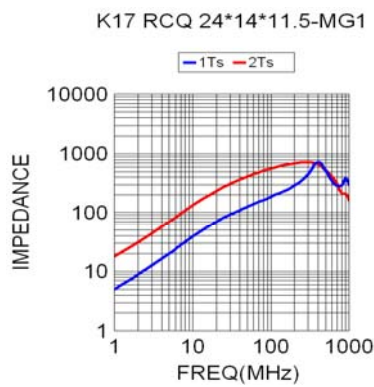
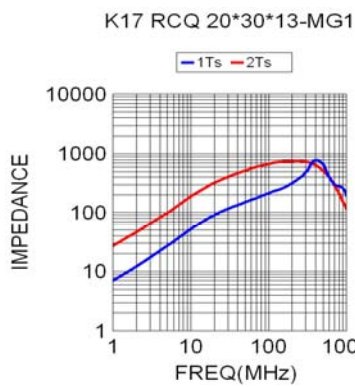
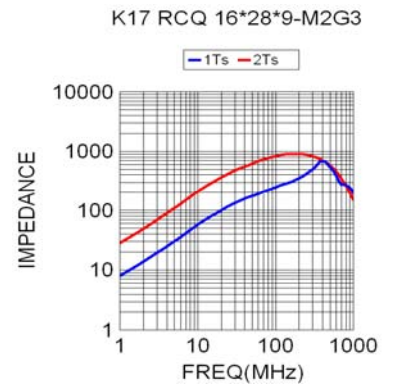
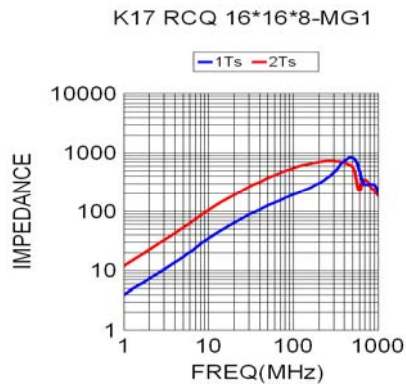
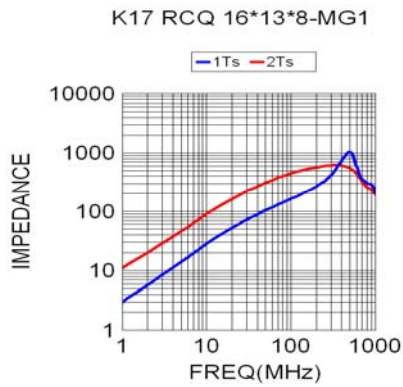
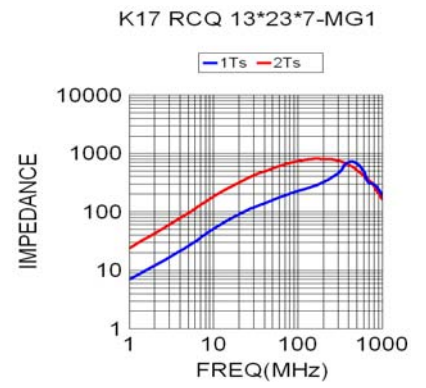
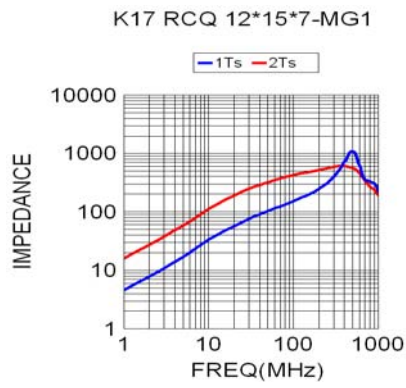
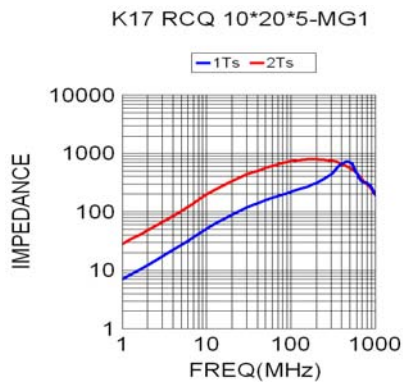

- \* WIRE:  $\Phi 0.5$  2UEW\*165mm\*1Ts,2Ts
- \* Operation temperature: -40 to +105 °C
- \* Storage Conditions (in original packaging): < 40 °C ; < 75 % RH

※Other sizes are available upon request.

※All the data listed in this catalogue are for reference only, King Core reserves the right to alter or revise the specifications without prior notification.